

Product Features

- wetted parts made of stainless steel
- with coupling nut for flat sealing connection thread including EPDM gasket
- press connection Geberit MAPRESS

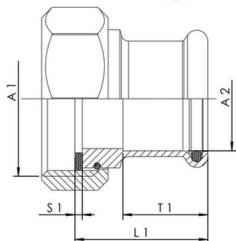

Standards and Approvals

- according to accepted materials list from German environmental agency
- DIN EN 1213
- ÖA-Reg.-Nr. R-15.2.3-21-17049, WIEN-ZERT

Part no.	DN	A1	A2 (mm)		L1 (mm)	S1 (mm)	T1 (mm)	kg
			15	18				
4762001500	15	G 3/4 G	22	28	31	2	20	0.07
4762001800	15	3/4 G 1	35	42	31	2	20	0.07
4762002000	20	G 1 1/4	54	76	32	2	21	0.1
4762002500	25	G 1 1/2	89		36	2	23	0.17
4762003200	32	G 1 3/4			39	2	26	0.2
476200400	4	G 2 3/8			43	2	30	0.24
0	0	G 3 G 3			50	3	35	0.43
4762005000	50	1/2			86	3	54	0.78
4762006500	65				96	3	53	1.13

476200800 8

0 0

Spare parts

- box with spare gaskets, figure 476 99 001
- EPDM gasket for union connections, figure C3100 476 07

FORHANDLER I NORGE
Froster AS - Sandviksveien 30, 5036 Bergen - Norge
 Tlf: +47 55 36 58 55 • post@froster.no • www.froster.no

